

Library Supporters

Clearwater Memorial Public Library
The library renovation project is COMPLETE!

THANK YOU!

DATE DUE
OVERDUE!
JUN 14 2023
CHECK IT OUT!

TO OUR INCREDIBLE COMMUNITY THAT HAS SUPPORTED THE LIBRARY EXPANSION PROJECT

A&A SEPTIC SERVICE
NICK ALBERS
JOE & KATHRYN ALBERTSON FAMILY
FOUNDATION
ASE, INC. SIGNS
AVISTA FOUNDATION
BARLOW TRUSS, INC.
BO BENSON
DEVON BUNYON
KELLY BURCH
CASTELLAW KOM ARCHITECTS
CITY OF OROFINO
CLEARWATER GLASS
CLEARWATER TRIBUNE
CREATIVE CONCRETE
CROSS CONTINUOUS GUTTERS
CROW ELECTRIC
DEBCO
EDWARD JONES
FORDS CREEK PUMP
4 STEMS CUSTOM BUILDERS
JIM FRANKLIN
FURY CONCRETE
GREEN THINGS
RON HANES
HANES-MILLER BOYS
HERCO
THE HIGH COUNTRY INN
IDAHO CORRECTIONAL (ICIO)
IDAHO YOUTH CHALLENGE

JAGOW CONSTRUCTION
JEFF JARRET
KLER
KLUDT DRYWALL
LEE LOGAN
LUCKY ACRES FENCING
MAX CONSTRUCTION
MIKE'S HEATING & AIR
MORRIS FAMILY
NIGHTFORCE OPTICS
OROFINO BUILDER'S SUPPLY
OROFINO DESIGN CENTER
OROFINO FLOWER SHOP
PIFCU
PAUL AND LEE PIPPENGER
P&L PLUMBING
RIVERVIEW CONSTRUCTION
ERIC ROBERTSON
ROTARY CLUB OF OROFINO
SALLY SHAWLEY
SCHWEITZER ENGINEERING LABORATORIES
SHOT GLASS - ALLISON DORLAND
DEWEY STEWART
STUDIO 205 - DIANE GEROT
TRIPCO
WINDOW ON THE CLEARWATER
ZANINI ALLEN FABRICATION
ZIPLY FIBER
... AND THE MANY OTHERS THAT HELPED
MAKE THIS POSSIBLE!!!

everyone is invited to our

GRAND OPENING

4PM WEDNESDAY

JUNE 14, 2023

402 MICHIGAN AVE. OROFINO, IDAHO

RSVP to cmplfoundinc@gmail.com or (208) 476-7570



Support as of 06/06/2023:

Phase 1 complete!

Phase 2 complete!

Phase 3 complete!

Phase 4 met!

Furnishings, etc: **\$22,662.49** GOAL: \$50,000.00



If you'd like to join our growing list of supporters, send your tax deductible donation to

CMPL Foundation, Inc.
139 High Country Lane
Ahsahka, ID 83520

Or use PayPal:

Donate via PayPal Giving Fund - 100% goes to CMPL Foundation, no fees!

Inquiries to cmplfoundationinc@gmail.com or call (208) 476-7570

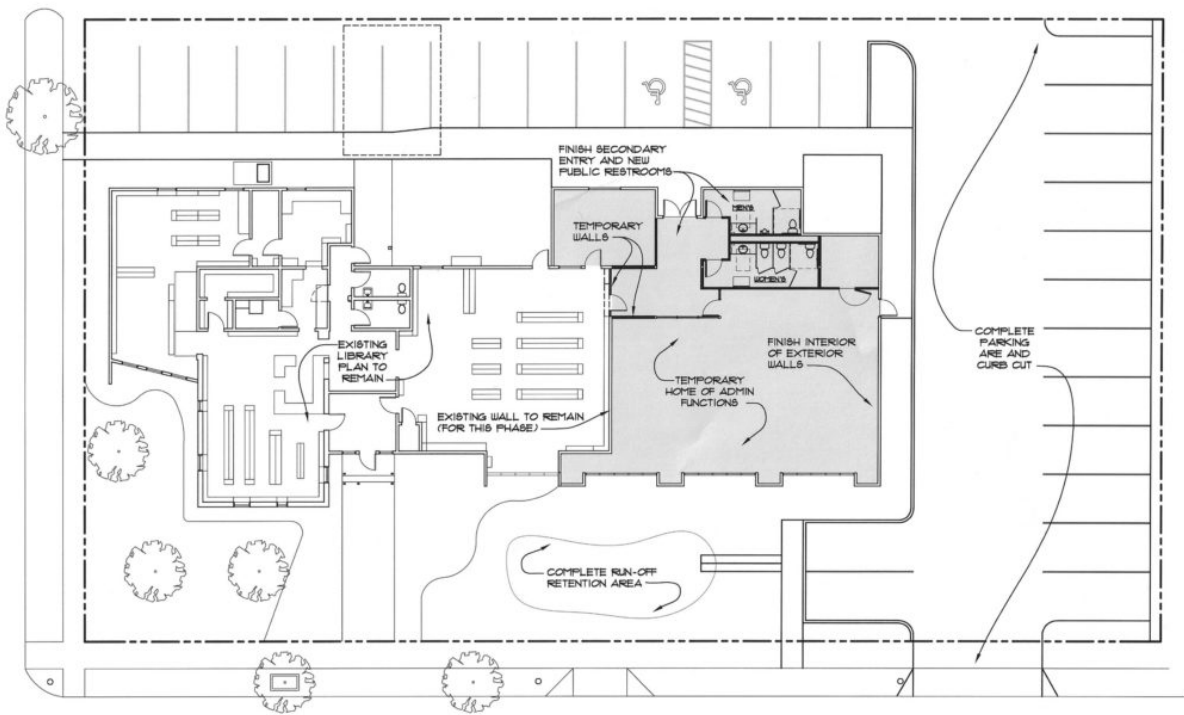

PHASE 2 - CLEARWATER MEMORIAL PUBLIC LIBRARY EXPANSION
SCALE: 1/16" = 1'-0"

Please let us know if have given and your name is not found on our list!

Donors (\$1-\$249):

Richard Alden, John & Rebecca Anderson, Kevin and Cynthia Bowen Angerine, Robert Roy Baird, Tim & Sharon Barnett, Marty Barth, Norman & Sharon Baugh, Dr. Nancy Berkhiser, Charlotte & Larry Boyd, Kathy Bird Breen, David Brock, John Brown, Dr. Vanessa Brown, Brad & Glenda Bull, Betty Burnham, Catherine Buttrick, Giovanna & Shannon Carducci, John & Patricia Case, Cleo Castellanos, Werner & Gertrude Christain, Edwynn Christophersen, CMPL Friends, Rodger & Diana Colgan, Marshall & Margaret Cook, Randall & Sharon Curtis, William & Mona Davis, Kathy & Tom Dougherty, Gerald & Freddi Engblom, Jean Evans, Norm & Barbara Fitzsimmons, Patricia (Masar) & Randall Flitz, Naomi Foote, Kay Mitchell Gaines, Larry and Lois Girton, Joseph & Ramona Gish, Nancy M. Godbey, Betty Halsey, Danielle Hardy, Jeannie Hodges, Judith Hook, Jack & Carla Jensen, Neal & Jeannie Johnson, Alysa Johnson, Marti Johnson, Ryan E. Johnson, John & Ann M. Judson, Dr. Rebecca Katzman, Robin & Dan Kenney, Tracy Kimberling, Joan Krupa, Roberta Leaton, Dr. Cynthia Lewis-Younger, Chris & Dr. Ann Lima, Ralph Lima, Judy Lofall, Marvin Lyness, Floyd & Dianne Marshall, Margaret Masar, Catherine Masar, Teresa Merritt, Josh & Taresa Michna, Tammy Jo Miller,

Richard & Rosan Monaghan, Alan & Karen Monroe, Paul Moroz, Morris Kids, Charles & Janet Mosier, Mary Ann Newcomer, North Fork Ranger District Association, North Fork Welfare Fund Association, Terry & Dianne Nygaard, Wayne & Leone Olson, Brian & Mary Palmer, Susan Pearce, TC & Annette Peterson, Mary Pipiun, Peggy Polito, Presnell Gage PLLC, Bernice Pullen, Karen Preussler, Marvin Reed, Louise Regelin, Roberta & Patricia Reggear, Dennis & Becky Riendeau, Judge Randy Robinson, Sandy Robinson, Susan Robinson, Mary & Gary Schroeder, Bill & Prudy Mitchell Schubach, Elbert & Hye Nan Snyder, St. Theresa's, Kathleen S. Thompson, Mark Thonen, Miles & Kathy Ulrich, Susan Van Allen, George & Katherine Vivian, Ken & Sally Vogt, John A. West, Susan Whipple, Cody & Sara Wilkinson, Mike Williams, Gary and Donna Wilson, Lee Ann Wilson

Charter Members (\$250-\$499):

AAA Precision Tool, CMPL Friends, Clearwater Valley Hospital and Clinics, Anonymous, Avista, Sam Bacharach, Michael & Pamela Bessent, Steve & Norma Brand, Merk & Lin Cannell, Clearwater County Land & Title, Con, Becca, & Gloria Cleto, CMPL Foundation, Stanley & Fay Freeman Cook, Dr. Adam C. & Hayley Dayley, OD PC, Bradford Delong, Craig & Tammy Gilmer, Jerry & Joanne Harris, Jimmy & Kelli Hutchens, Dan & Jean Cleto Johnson, Monica Jones, John & Bobbi Lagerquist, Irene Lamberti, Leach Family Rev Living Trust, Lawrence & Shelley Long, Sandy Love, Gerald (Guido) & Pamela MacGuffie, Siphon Mathabela, Rosan Monaghan, Annie Mosier, Paul & Rita Nemeth, Jeffrey & Theresa Nessett, Jim & Vicky O'Leary, Paul & Kathy Pence, Irene Rea, Kenneth N. Rea, Charles & Linda Reid, Eric Ringsred, Susan Sparano, VFW Harold Kinne Post 3296, George & Kathrine Vivian, Julie & Pat West, Gordon & Ginny White, Dr. Michael & April Williams, Betty Zech

Advocates (\$500-\$999):

Clearwater Valley Hospital Providers, King's, Orofino Physical Therapy, John & Kathryn Allen, Robert Bailey and June Weber, Banner Bank, Dale Cox, Esq., Leslie Duke, John & Sandy Goffinet, Kiwanas, Konkolville Water District, Amy Lientz, Charlotte Anne Lindsley with Kimberly & Angie, Cathy Masar, Caroline & Rick Masar-Miller, Dennis & Lane Mayer, McLaughlin Logging, Edward & Traci Moore, Ed Moore, Josh & Kc Morris, Nightforce, Jon & Ann Nilsson, Charlotte Omoto & Gale Schultz, The Shot Glass, Norman & Ellen Tomlinson, Darin & Tracy

Tucker, Matt & Susan Turner, Will Weise & Pat Larson, Mike Williams

Benefactors (\$1000-\$4999):

Ted & JoAnne Albright, Anonymous, Dennis Berkheiser, William & Mary Borkett, Burns McDonnell, Cast & Blast Members, Billy & Gail Chapman, Dorothy Duclarme, Melissa (Ray) & Chris Elkinton, Ray & Kitty Geidl, Rodney & Noelle Grant, Hal & Leslie Harber, Mavel Hathaway, Mike & Denise Hedrick, Idaho Community Foundation, Paula & Jim Lohmeyer, Paul Kaplan, Lynn & Eric Maceachern, Scott and Lori McDonald, Scott & Anne Moore, Jo Moore, NW Farmers Cooperative, Maurice "Mo" Pare, Dale & Brigitte Richardson, Ruth Root, Sabre Industries, Inc., Matt Sartini, Jo Sharrai, Shopko, Mike & Belinda Stockton, Jack & Jude Vosika, John & Lucy Werner, Linda Werner, Allen Xi

Legacy (\$5000+):

City of Orofino, Clearwater Memorial Public Library, Dworshak Recreation District, Idaho Forest Group, Inland Northwest Area Foundation, J. A. and Kathryn Albertson Family Foundation, Laura Moore Cunningham Foundation, P1FCU, Schweitzer Engineering Laboratories, Jim & Vicki Everrett, Richard & Deborah Haveman, Orofino Builder's Supply, Paul & Lee Pippenger, Ed & Beatriz Schweitzer, Sally Shawley

Sponsors:

Angler's Inn, ASE Signs, Fords Creek Pump, Clearwater Concrete, Clearwater Tribune, Haskett Photography, Montgomery Distillery, NightForce, Orofino Physical Therapy, P1FCU, Poofy Organics, Rotary, The High Country Inn, Window on the Clearwater, AAA Precision Tool, Avista Foundation, Banner Bank, Burns McDonnell, Cast & Blast, City of Orofino, Clearwater County Land Title Co, Clearwater Memorial Public Library, Clearwater Realty, Clearwater Valley Hospital, CMPL Friends, Dworshak Recreation District, Edward Jones, Fine Gold Campers, Idaho Community Foundation, Kings, Konkolville Water District, Laura Moore Cunningham, McLaughlin Logging, NW Inland, Orofino Physical Therapy, Pacific NW Farmer's Cooperative, Presnell Gage PLLC, The Red Shed, Sabre Industries, Schweitzer Engineering Laboratories, Scrapbookers (Becky Mahurin), Shopko, The Shot Glass, Tripco Inc., Idaho Forest Group, Orofino Builder's Supply, Valley Equipment Rentals, A & A Septic, KLER, Fury Concrete, Rotary

Club, Red Shirts, Thor's Forge